

Part

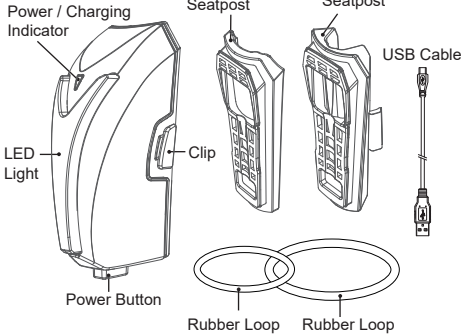

USB Charging

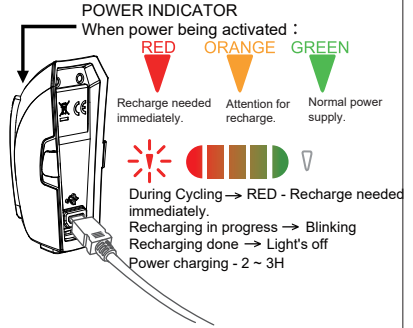

Mounting

Tie both sides with Rubber Band. ① & ②

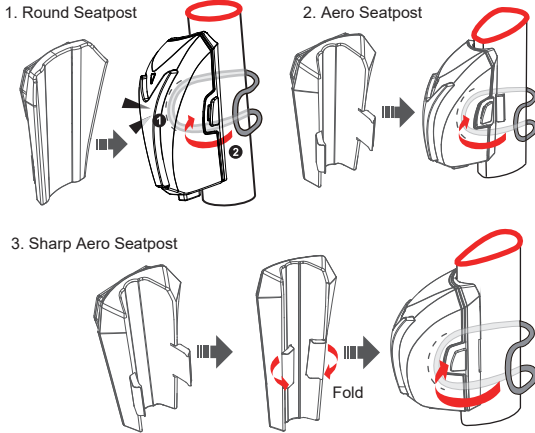

Attentions

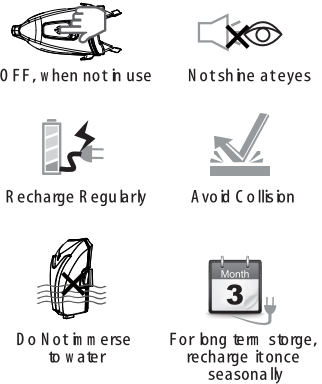

Operation

Power Switch → Auto Mode → Manual Mode → Repeat Press 1 Second OFF Auto Mode

DAYTIME: a. Light's off while in the Daytime.
b. Light's on automatically when passing through the Tunnel, Underpass, Parking Lot in Basement or Raining where's insufficient surrounding light.

NIGHTTIME: a. Light's on automatically while in the evening.
b. Auto off after bike being parked in 60s.
Auto on when bike being ridden again.
Manual Mode-Switch on the light manually.

Performance index

1. Comply with SIVZO 22A, TA14 (III)
2. Powered and tested under the 3.7V / 550mAh Lithium Batt.
Runtime ≥ 6H

Specifications

LED: 9 pcs x RED LED &
1 pc Green LED (Indicator)
1 pc Red LED (Indicator)
Batt.: 3.7V / 550mAh Lithium Batt.
Material: ABS / PC
Size: 42 x 29 x 77mm
Weight: 39g
Water Resistant: IPX 4

